

Strut Profile PG40

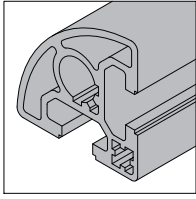

PG40 40x40 R90 2 slots

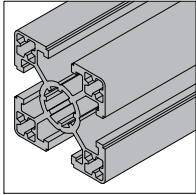

PG40 40x40 4 slots Super Light

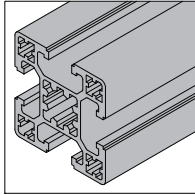

PG40 40x40 4 slots Light

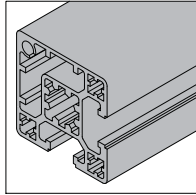

PG40 40x40 2 slots Type A

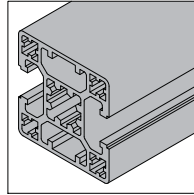

PG40 40x40 2 slots Type B

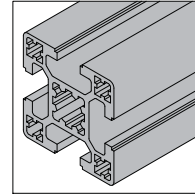

PG40 40x40 4 slots

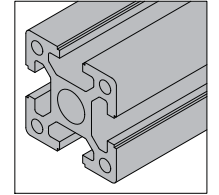

PG40 40x40 4 slots Heavy

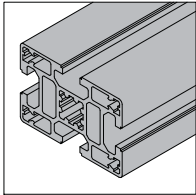

PG40 40x60 4 slots

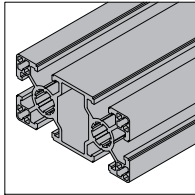

PG40 40x80 6 slots Super Light

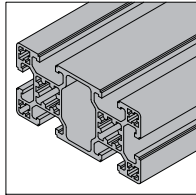

PG40 40x80 6 slots Light

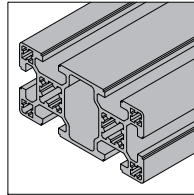

PG40 40x80 6 slots

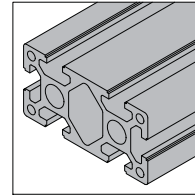

PG40 40x80 6 slots Heavy

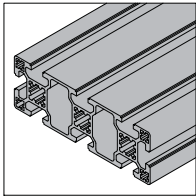

PG40 40x120 8 slots

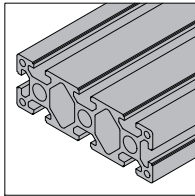

PG40 40x120 8 slots Heavy

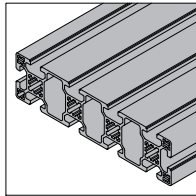

PG40 40x160 10 slots

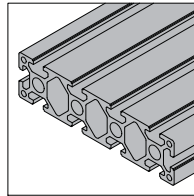

PG40 40x160 10 slots Heavy

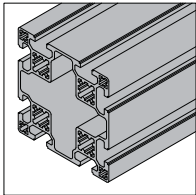

PG40 80x80 8 slots

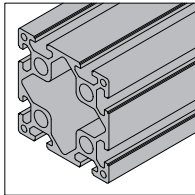

PG40 80x80 8 slots Heavy

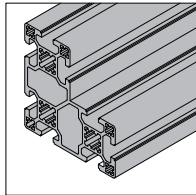

PG40 80x80 L 8 slots

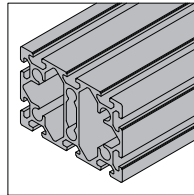

PG40 80x120 10 slots

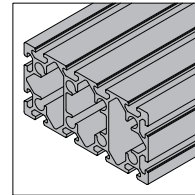

PG40 80x160 12 slots

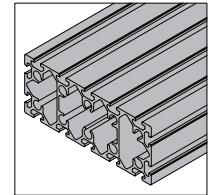

PG40 80x200 14 slots

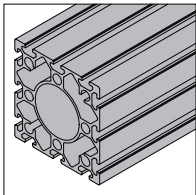

PG40 120x120 12 slots

Strut profile PG40 featuring 10mm T-slot is designed for constructing medium to heavy weight assemblies, such as work station, machinery frame, exhibition stands, conveyors assemblies etc. (Profiles of PG40 are frequently used in China).

Connector selection: anchor connector, die cast bracket, angle profile bracket, inner bracket, linear bar connector etc.

Strut Profile PG40

PG40 40x40 R90 2 slots

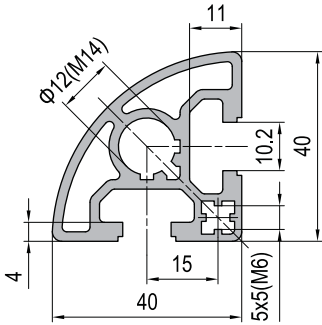

PG40 40x40 4 slots Super Light

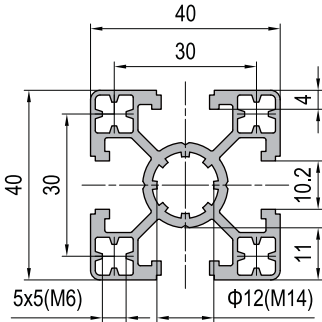

PG40 40x40 4 slots Light

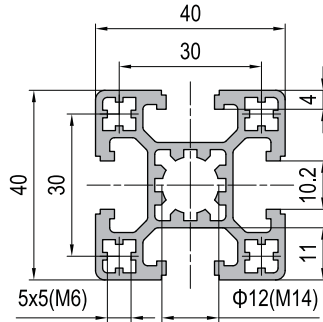

PG40 40x40 2 slots Type A

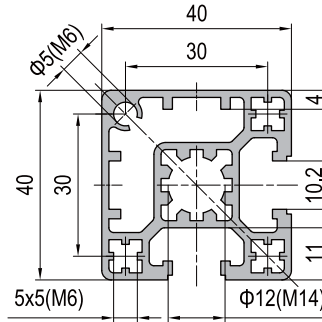

PG40 40x40 2 slots Type B

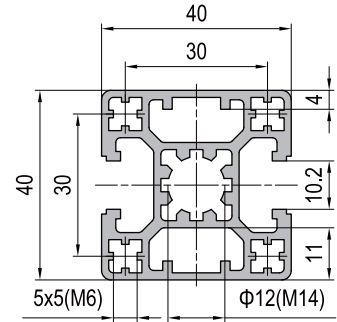

PG40 40x40 4 slots

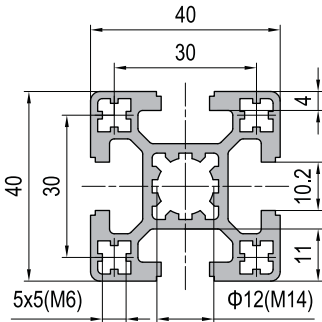

PG40 40x40 4 slots Heavy

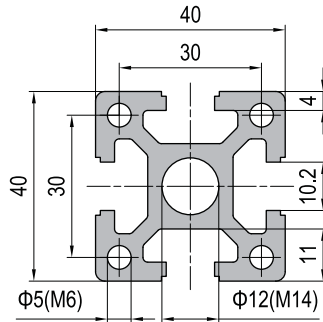

PG40 40x60 4 slots

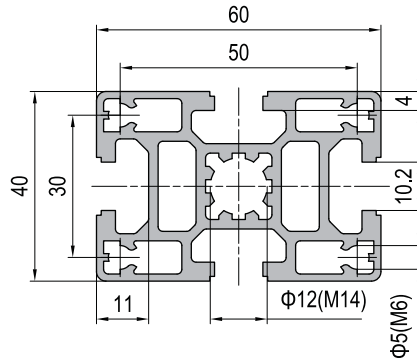

Description	Moment of Inertia Ix(cm ⁴)	Moment of Inertia Iy(cm ⁴)	Moment of Resistance Wx(cm ³)	Moment of Resistance Wy(cm ³)	Mass (kg/m)	Part No.
Strut Profile PG40 40x40 R90 2 slots	8.3	4.8	3.0	1.9	1.3	1.11.40.040040.R90.02
Strut Profile PG40 40x40 4 slots Super Light	7.3	7.3	3.6	3.6	1.3	1.11.40.040040.04SL
Strut Profile PG40 40x40 4 slots Light	8.6	8.6	4.3	4.3	1.5	1.11.40.040040.04L
Strut Profile PG40 40x40 2 slots Type A	9.6	9.6	4.5	4.5	1.5	1.11.40.040040.02A
Strut Profile PG40 40x40 2 slots Type B	9.6	8.6	4.8	4.3	1.5	1.11.40.040040.02B
Strut Profile PG40 40x40 4 slots	9.1	9.1	4.6	4.6	1.6	1.11.40.040040.04
Strut Profile PG40 40x40 4 slots Heavy	11.5	11.5	5.8	5.8	2.0	1.11.40.040040.04H
Strut Profile PG40 40x60 4 slots	13.3	27.6	6.6	9.2	2.3	1.11.40.040060.04

Strut Profile PG40

PG40 40x80 6 slots Super Light

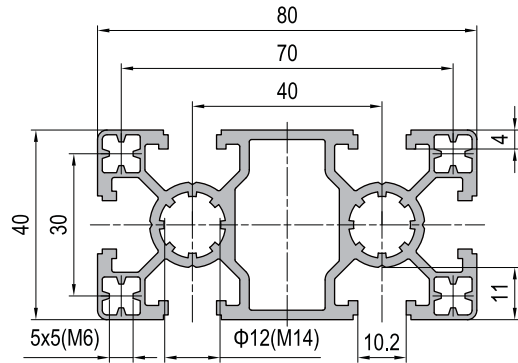

PG40 40x80 6 slots Light

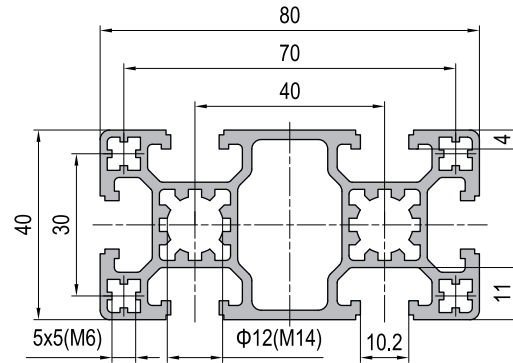

PG40 40x80 6 slots

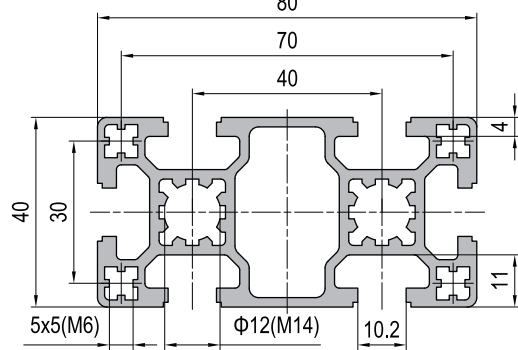

PG40 40x80 6 slots Heavy

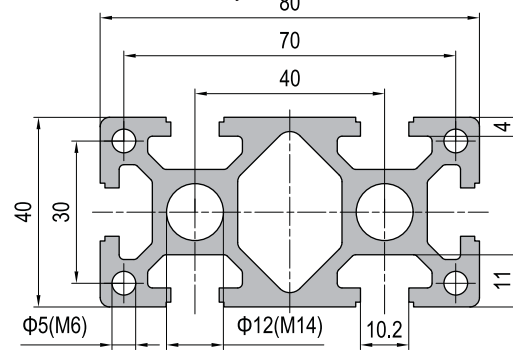

PG40 40x120 8 slots

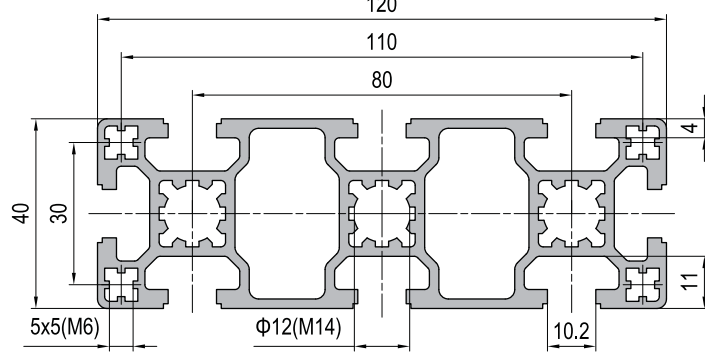

PG40 40x120 8 slots Heavy

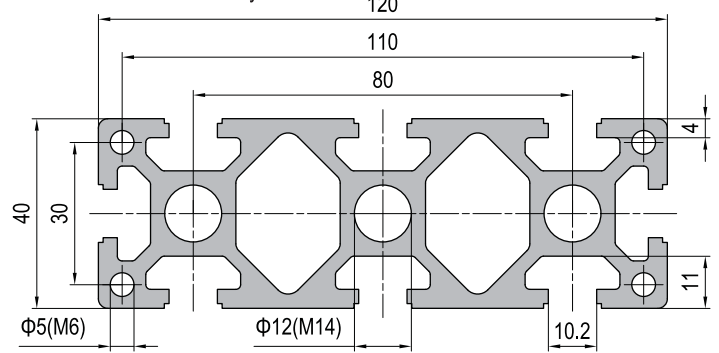

Description	Moment of Inertia $I_x(\text{cm}^4)$	Moment of Inertia $I_y(\text{cm}^4)$	Moment of Resistance $W_x(\text{cm}^3)$	Moment of Resistance $W_y(\text{cm}^3)$	Mass (kg/m)	Part No.
Strut Profile PG40 40x80 6 slots Super Light	14.3	52.0	7.2	13.0	2.3	1.11.40.040080.06SL
Strut Profile PG40 40x80 6 slots Light	15.8	59.1	7.9	14.8	2.5	1.11.40.040080.06L
Strut Profile PG40 40x80 6 slots	16.6	63.2	8.3	15.8	2.7	1.11.40.040080.06
Strut Profile PG40 40x80 6 slots Heavy	22.2	80.8	11.1	20.2	3.6	1.11.40.040080.06H
Strut Profile PG40 40x120 8 slots	24.1	194.8	12.1	32.5	3.8	1.11.40.040120.08
Strut Profile PG40 40x120 8 slots Heavy	33.0	255.3	16.5	42.6	5.2	1.11.40.040120.08H

Strut Profile PG40

PG40 40x160 10 slots

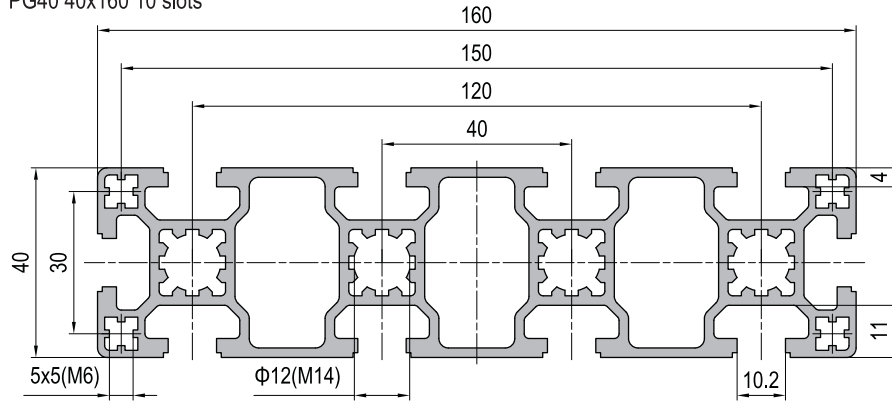

PG40 40x160 10 slots Heavy

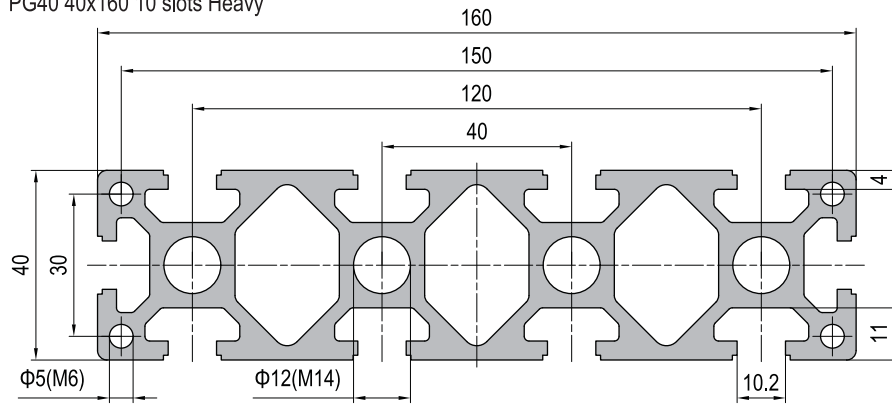

PG40 80x80 8 slots

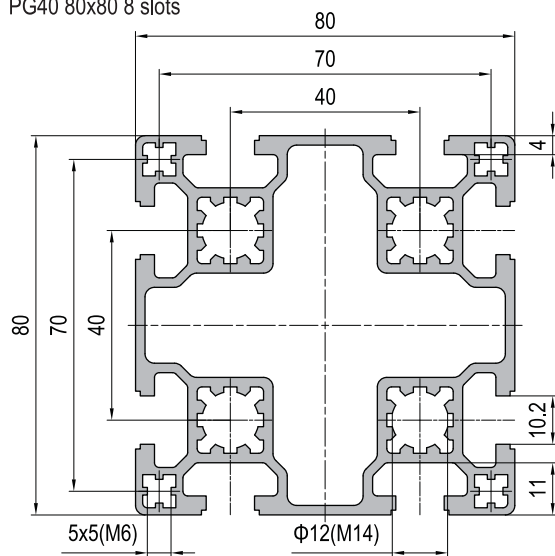

PG40 80x80 8 slots Heavy

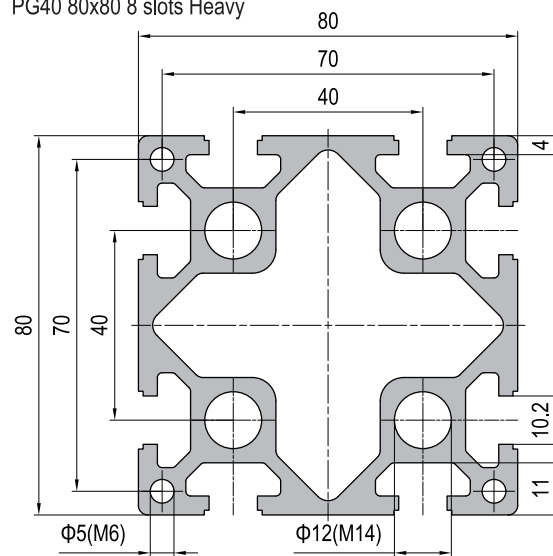

Description	Moment of Inertia $I_x(\text{cm}^4)$	Moment of Inertia $I_y(\text{cm}^4)$	Moment of Resistance $W_x(\text{cm}^3)$	Moment of Resistance $W_y(\text{cm}^3)$	Mass (kg/m)	Part No.
Strut Profile PG40 40x160 10 slots	31.6	435.7	15.8	54.5	4.8	1.11.40.040160.10
Strut Profile PG40 40x160 10 slots Heavy	43.7	582.2	21.8	72.8	6.8	1.11.40.040160.10H
Strut Profile PG40 80x80 8 slots	109.9	109.9	27.5	27.5	4.2	1.11.40.080080.08
Strut Profile PG40 80x80 8 slots Heavy	148.2	148.2	37.1	37.1	5.7	1.11.40.080080.08H

Strut Profile PG40

PG40 80x80 L 8 slots

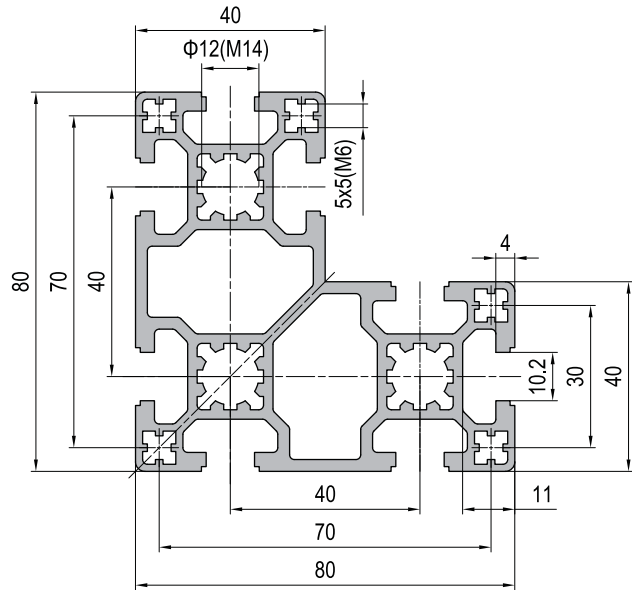

PG40 80x120 10 slots

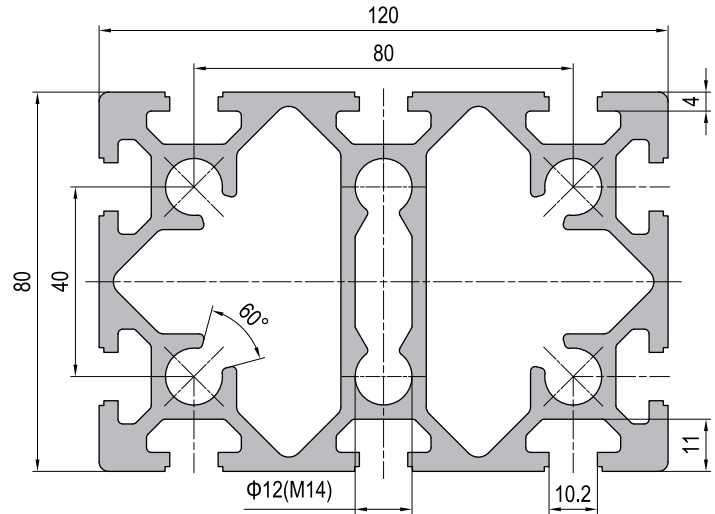

PG40 80x160 12 slots

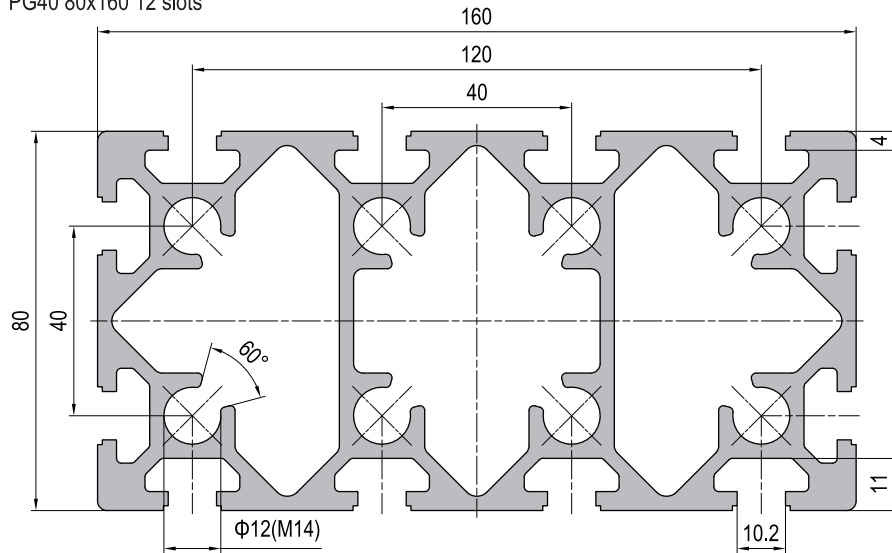

Description	Moment of Inertia $I_x(\text{cm}^4)$	Moment of Inertia $I_y(\text{cm}^4)$	Moment of Resistance $W_x(\text{cm}^3)$	Moment of Resistance $W_y(\text{cm}^3)$	Mass (kg/m)	Part No.
Strut Profile PG40 80x80 L 8 slots	111.8	56.0	20.1	11.9	4.0	1.11.40.080080L.08
Strut Profile PG40 80x120 10 slots	222.1	449.2	55.5	74.8	8.3	1.11.40.080120.10
Strut Profile PG40 80x160 12 slots	287.5	975.5	71.9	121.9	9.6	1.11.40.080160.12

Strut Profile PG40

PG40 80x200 14 slots

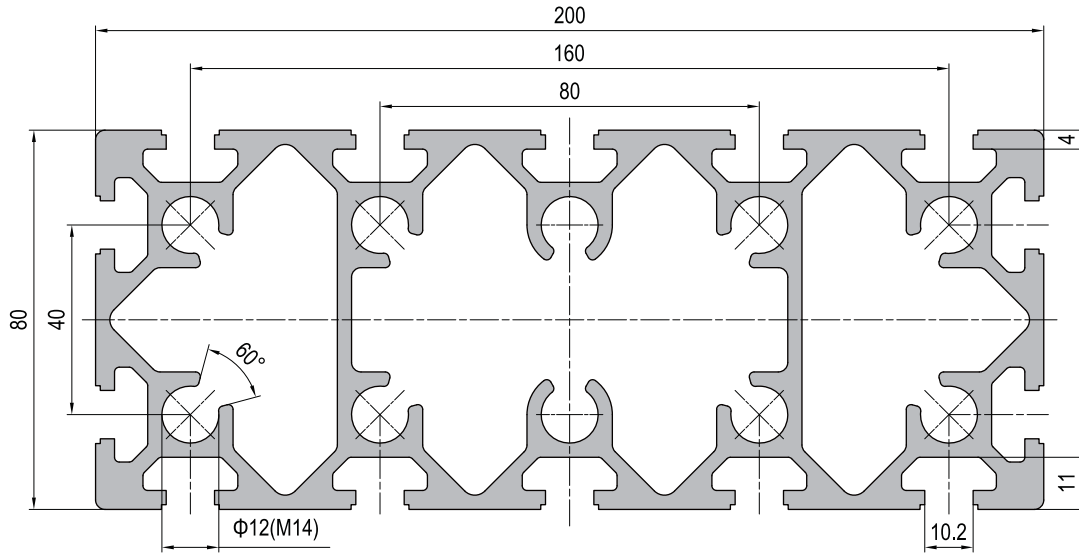

PG40 120x120 12 slots

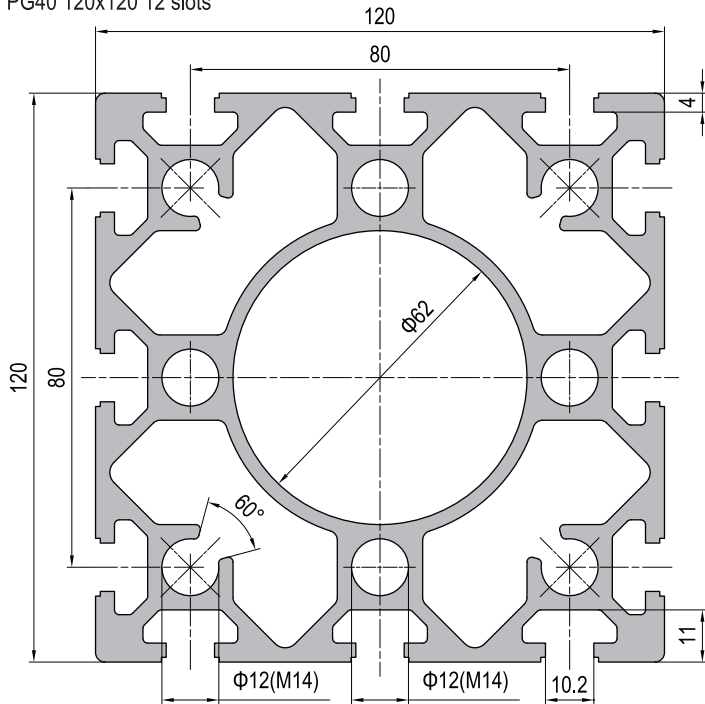

Description	Moment of Inertia $I_x(\text{cm}^4)$	Moment of Inertia $I_y(\text{cm}^4)$	Moment of Resistance $W_x(\text{cm}^3)$	Moment of Resistance $W_y(\text{cm}^3)$	Mass (kg/m)	Part No.
Strut Profile PG40 80x200 14 slots	353.1	1789.8	88.3	179.0	12.0	1.11.40.080200.14
Strut Profile PG40 120x120 12 slots	659.1	659.1	109.9	109.9	11.0	1.11.40.120120.12