

Connecting Elements

Die Cast Bracket-PG30-30x30

Material : die cast aluminium alloy

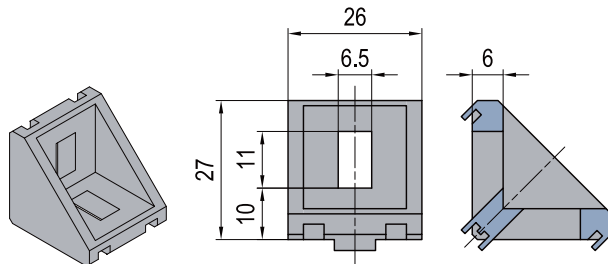
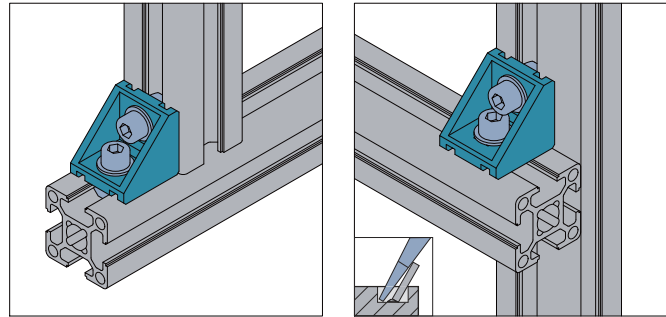

A	Fastening Set	B	Fastening Set
	M6x14 Bolt zinc plated		M6x14 Bolt zinc plated
	M6 Washer zinc plated		M6 Washer zinc plated
	M6 T-nut nickel plated		M6 Pre-set Nut nickel plated
Reliability ★★★★★		Reliability ★★★★★	
Efficiency ★★★★★		Efficiency ★★★★★	
Cost ★★★★★		Cost ★★★★★	

Description	Fastening Set	Mass (g)	Part No.
Die Cast Bracket-PG30-30x30 (pcs)		21	3.21.30.3030
Die Cast Bracket-PG30-30x30 (set A)	2xA	42	3.21.30.3030.STA
Die Cast Bracket-PG30-30x30 (set B)	2xB	48	3.21.30.3030.STB

Connecting Elements

Die Cast Bracket-PG30-30x60

Material : die cast aluminium alloy

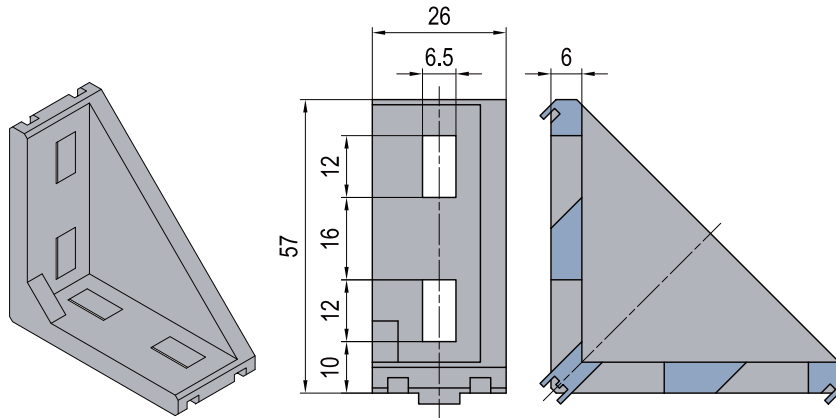
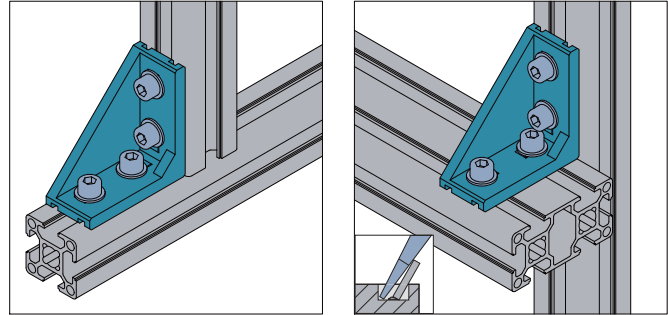

A	Fastening Set
	M6x14 Bolt zinc plated
	M6 Washer zinc plated
	M6 T-nut nickel plated
Reliability ★★★★★	
Efficiency ★★★★★	
Cost ★★★★★	

B	Fastening Set
	M6x14 Bolt zinc plated
	M6 Washer zinc plated
	M6 Pre-set Nut nickel plated
Reliability ★★★★★	
Efficiency ★★★★★	
Cost ★★★★★	

Description	Fastening Set	Mass (g)	Part No.
Die Cast Bracket-PG30-30x60 (pcs)		53	3.21.30.3060
Die Cast Bracket-PG30-30x60 (set A)	4xA	93	3.21.30.3060.STA
Die Cast Bracket-PG30-30x60 (set B)	4xB	105	3.21.30.3060.STB

Connecting Elements

Die Cast Bracket-PG30-60x60

Material : die cast aluminium alloy

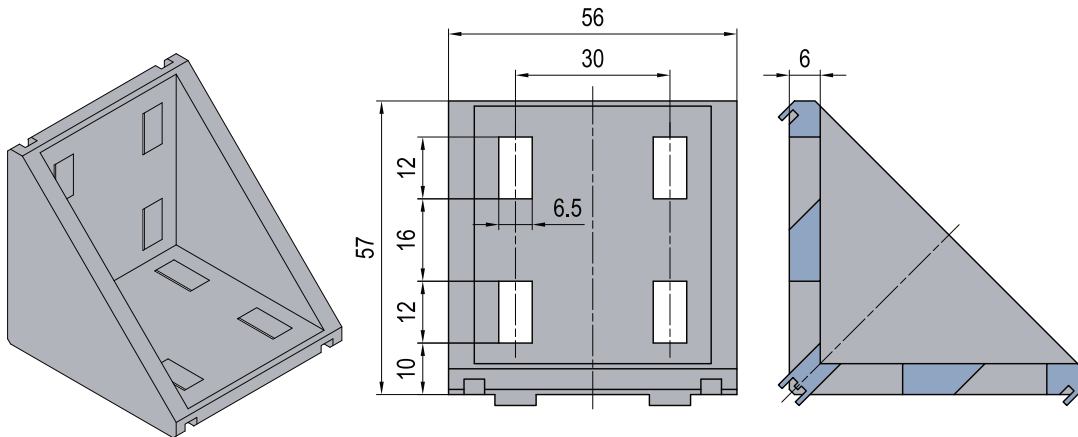
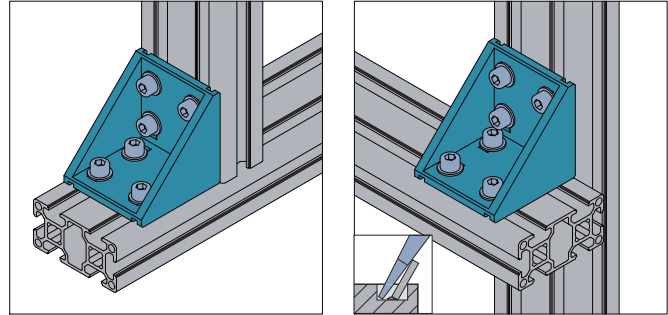

A	Fastening Set	B	Fastening Set
	M6x14 Bolt zinc plated		M6x14 Bolt zinc plated
	M6 Washer zinc plated		M6 Washer zinc plated
	M6 T-nut nickel plated		M6 Pre-set Nut nickel plated
Reliability	★★★★	Reliability	★★★★★
Efficiency	★★★★★	Efficiency	★★★
Cost	★★★★★	Cost	★★★★

Description	Fastening Set	Mass (g)	Part No.
Die Cast Bracket-PG30-60x60 (pcs)		120	3.21.30.6060
Die Cast Bracket-PG30-60x60 (set A)	8xA	200	3.21.30.6060.STA
Die Cast Bracket-PG30-60x60 (set B)	8xB	224	3.21.30.6060.STB

Connecting Elements

Die Cast Bracket-PG40-40x40

Material : die cast aluminium alloy

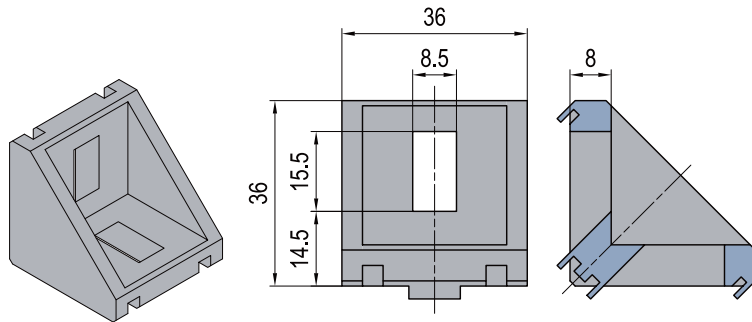
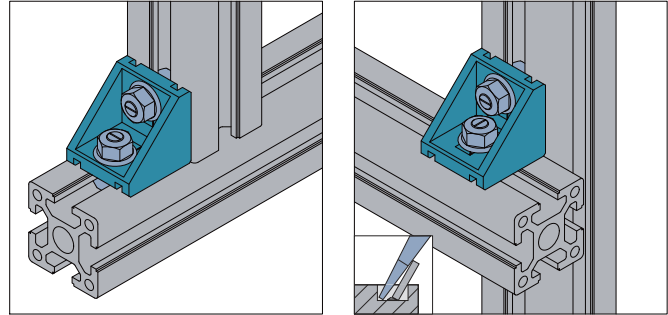

C Fastening Set

- M8 Flange Locknut zinc plated
- M8x20 T-blot nickel plated

Reliability ★★★★★
Efficiency ★★★★★
Cost ★★★★★

D Fastening Set

- M8x20 Bolt zinc plated
- M8 Washer zinc plated
- M8 T-nut nickel plated

Reliability ★★★
Efficiency ★★★★★
Cost ★★★★★

E Fastening Set

- M8x20 Bolt zinc plated
- M8 Washer zinc plated
- M8 Pre-set Nut nickel plated

Reliability ★★★★★
Efficiency ★★★
Cost ★★★★★

Description	Fastening Set	Mass (g)	Part No.
Die Cast Bracket-PG40-40x40 (pcs)		50	3.21.40.4040
Die Cast Bracket-PG40-40x40 (set C)	2xC	92	3.21.40.4040.STC
Die Cast Bracket-PG40-40x40 (set D)	2xD	92	3.21.40.4040.STD
Die Cast Bracket-PG40-40x40 (set E)	2xE	106	3.21.40.4040.STE

Connecting Elements

Die Cast Bracket-PG40-40x80

Material : die cast aluminium alloy

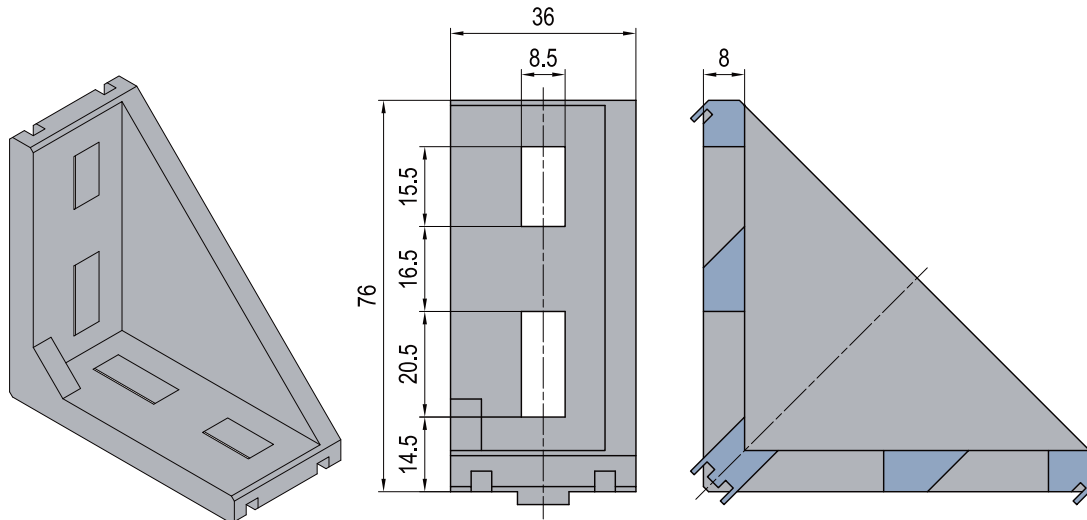
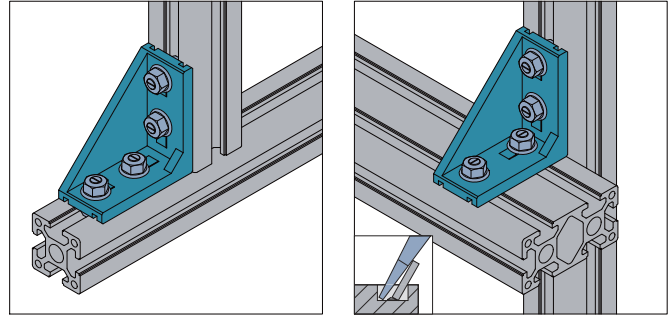

C	Fastening Set	F	Fastening Set	G	Fastening Set
	M8 Flange Locknut zinc plated		M8x20 Bolt zinc plated		M8x20 Bolt zinc plated
	M8x20 T-blot nickel plated		M8 Spring Washer zinc plated		M8 Spring Washer zinc plated
			M8 Washer zinc plated		M8 Washer zinc plated
			M8 T-nut nickel plated		M8 Pre-set Nut nickel plated
Reliability	★★★★★	Reliability	★★★	Reliability	★★★★
Efficiency	★★★★★	Efficiency	★★★★★	Efficiency	★★★
Cost	★★★★★	Cost	★★★★★	Cost	★★★★

Description	Fastening Set	Mass (g)	Part No.
Die Cast Bracket-PG40-40x80 (pcs)		125	3.21.40.4080
Die Cast Bracket-PG40-40x80 (set C)	4xC	210	3.21.40.4080.STC
Die Cast Bracket-PG40-40x80 (set F)	4xF	220	3.21.40.4080.STF
Die Cast Bracket-PG40-40x80 (set G)	4xG	250	3.21.40.4080.STG

Connecting Elements

Die Cast Bracket-PG40-80x80

Material : die cast aluminium alloy

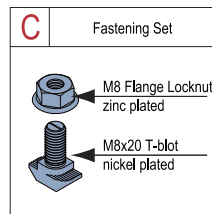
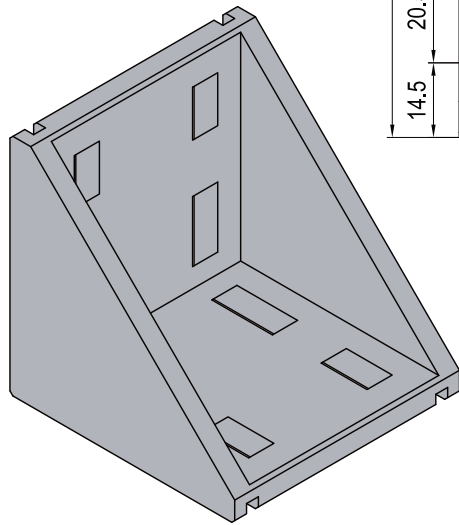
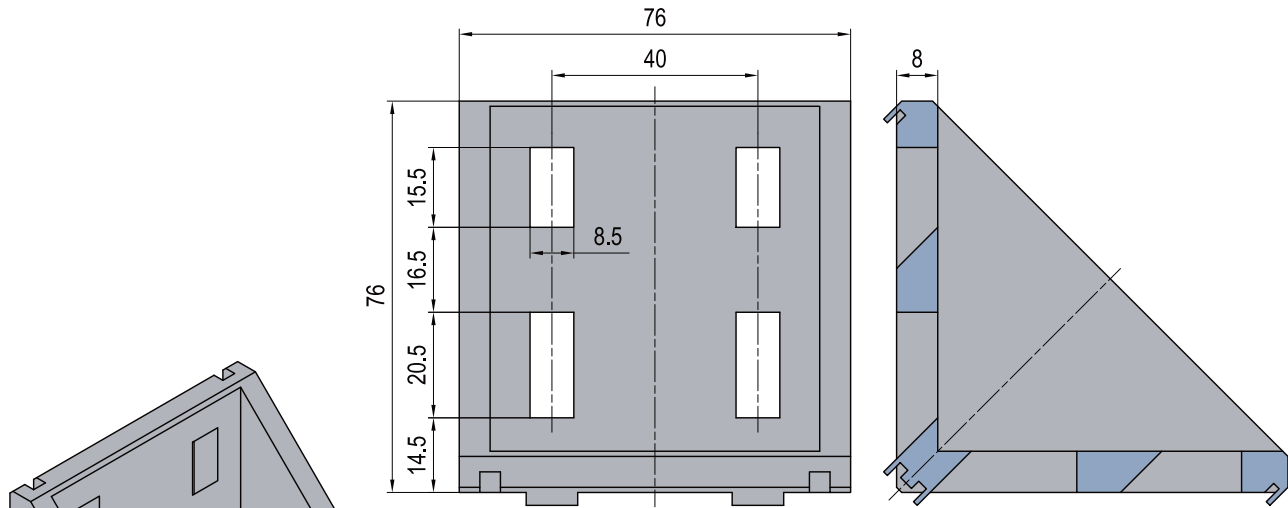
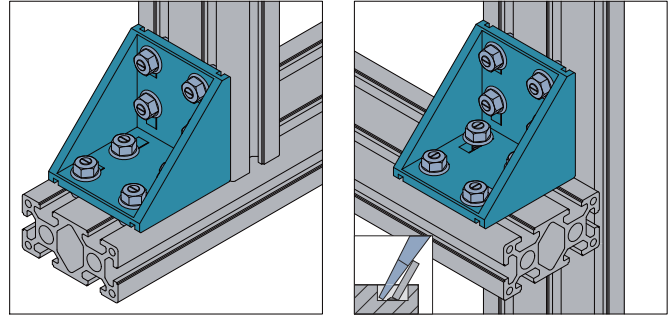

Reliability ★★★★★
Efficiency ★★★★★
Cost ★★★★★

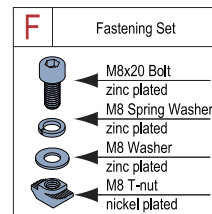

Reliability ★★★
Efficiency ★★★★★
Cost ★★★★★

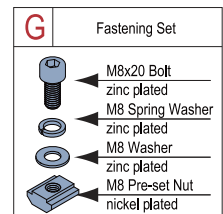

Reliability ★★★★★
Efficiency ★★★
Cost ★★★★★

Description	Fastening Set	Mass (g)	Part No.
Die Cast Bracket-PG40-80x80 (pcs)		260	3.21.40.8080
Die Cast Bracket-PG40-80x80 (set C)	8xC	428	3.21.40.8080.STC
Die Cast Bracket-PG40-80x80 (set F)	8xF	452	3.21.40.8080.STF
Die Cast Bracket-PG40-80x80 (set G)	8xG	508	3.21.40.8080.STG

Connecting Elements

Die Cast Bracket-PG45-45x45

Material : die cast aluminium alloy

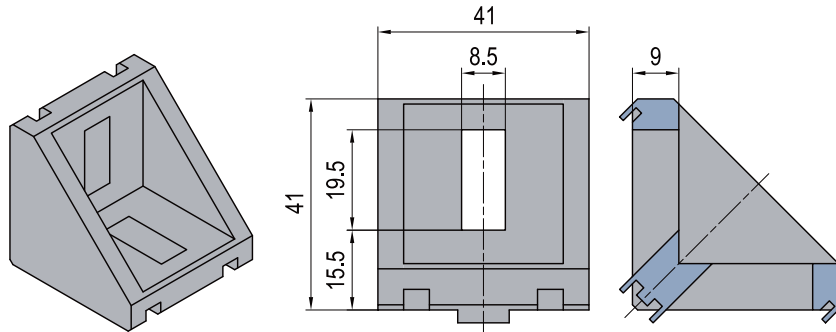
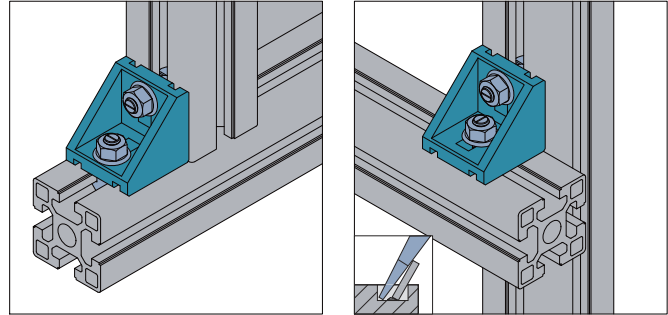

H Fastening Set

- M8 Flange Locknut zinc plated
- M8x25 T-blot nickel plated

Reliability ★★★★★
Efficiency ★★★★★
Cost ★★★★★

J Fastening Set

- M8x25 Bolt zinc plated
- M8 Spring Washer zinc plated
- M8 Washer zinc plated
- M8 T-nut nickel plated

Reliability ★★★
Efficiency ★★★★★
Cost ★★★★★

K Fastening Set

- M8x25 Bolt zinc plated
- M8 Spring Washer zinc plated
- M8 Washer zinc plated
- M8 Pre-set Nut nickel plated

Reliability ★★★
Efficiency ★★★
Cost ★★★

Description	Fastening Set	Mass (g)	Part No.
Die Cast Bracket-PG45-45x45 (pcs)		72	3.21.45.4545
Die Cast Bracket-PG45-45x45 (set H)	2xH	118	3.21.45.4545.STH
Die Cast Bracket-PG45-45x45 (set J)	2xJ	122	3.21.45.4545.STJ
Die Cast Bracket-PG45-45x45 (set K)	2xK	134	3.21.45.4545.STK

Connecting Elements

Die Cast Bracket-PG45-45x90

Material : die cast aluminium alloy

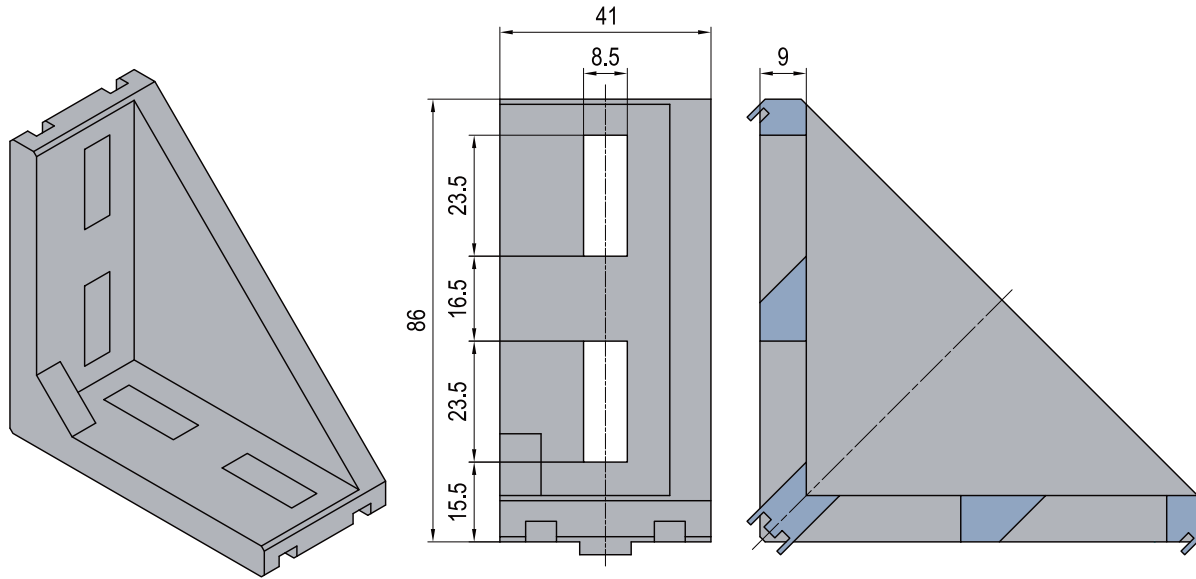
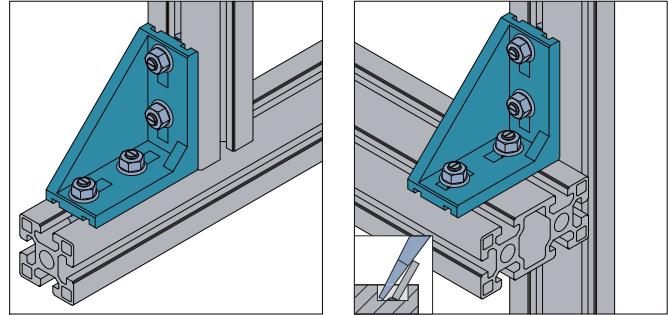

H Fastening Set

- M8 Flange Locknut zinc plated
- M8x25 T-blot nickel plated

Reliability ★★★★★
Efficiency ★★★★★
Cost ★★★★★

J Fastening Set

- M8x25 Bolt zinc plated
- M8 Spring Washer zinc plated
- M8 Washer zinc plated
- M8 T-nut nickel plated

Reliability ★★★
Efficiency ★★★★★
Cost ★★★★★

K Fastening Set

- M8x25 Bolt zinc plated
- M8 Spring Washer zinc plated
- M8 Washer zinc plated
- M8 Pre-set Nut nickel plated

Reliability ★★★
Efficiency ★★★
Cost ★★★★★

Description	Fastening Set	Mass (g)	Part No.
Die Cast Bracket-PG45-45x90 (pcs)		190	3.21.45.4590
Die Cast Bracket-PG45-45x90 (set H)	4xH	282	3.21.45.4590.STH
Die Cast Bracket-PG45-45x90 (set J)	4xJ	290	3.21.45.4590.STJ
Die Cast Bracket-PG45-45x90 (set K)	4xK	314	3.21.45.4590.STK

Connecting Elements

Die Cast Bracket-PG45-90x90

Material : die cast aluminium alloy

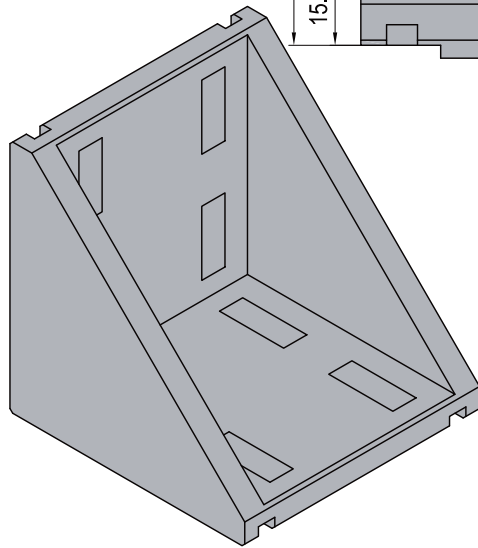
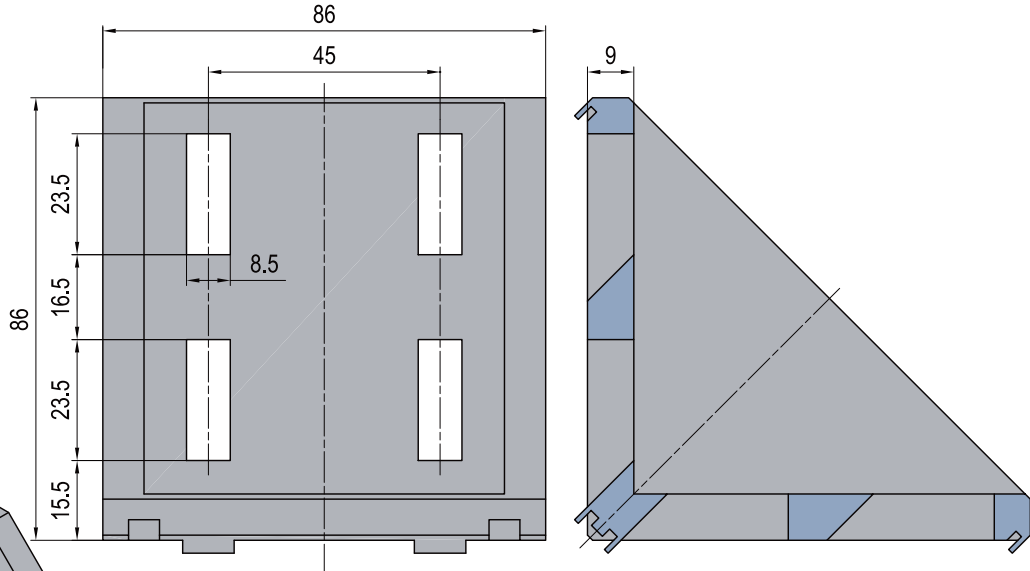
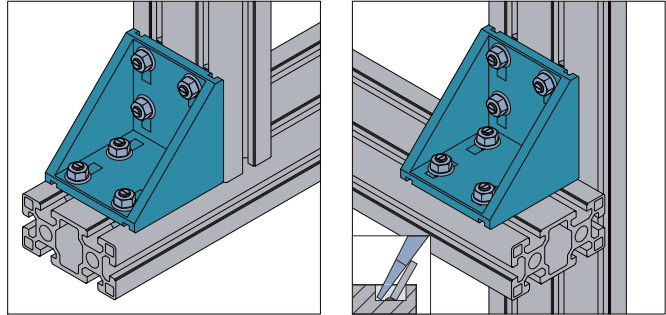

H Fastening Set

- M8 Flange Locknut zinc plated
- M8x25 T-blot nickel plated

Reliability ★★★★★
Efficiency ★★★★★
Cost ★★★★★

J Fastening Set

- M8x25 Bolt zinc plated
- M8 Spring Washer zinc plated
- M8 Washer zinc plated
- M8 T-nut nickel plated

Reliability ★★★
Efficiency ★★★★★
Cost ★★★★★

K Fastening Set

- M8x25 Bolt zinc plated
- M8 Spring Washer zinc plated
- M8 Washer zinc plated
- M8 Pre-set Nut nickel plated

Reliability ★★★★★
Efficiency ★★★
Cost ★★★★★

Description	Fastening Set	Mass (g)	Part No.
Die Cast Bracket-PG45-90x90 (pcs)		390	3.21.45.9090
Die Cast Bracket-PG45-90x90 (set H)	8xH	574	3.21.45.9090.STH
Die Cast Bracket-PG45-90x90 (set J)	8xJ	590	3.21.45.9090.STJ
Die Cast Bracket-PG45-90x90 (set K)	8xK	638	3.21.45.9090.STK